



Classical Leg set
E10 CHR
E10 WHI
E10 BLA



Period Leg set
E9 CHR
E9 WHI
E9 BLA



Traditional Leg set
E11 CHR
E11 WHI
E11 BLA

Tools required:

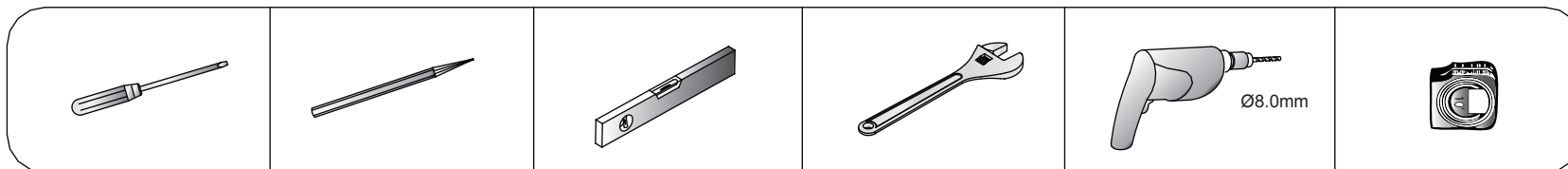

Parts supplied:

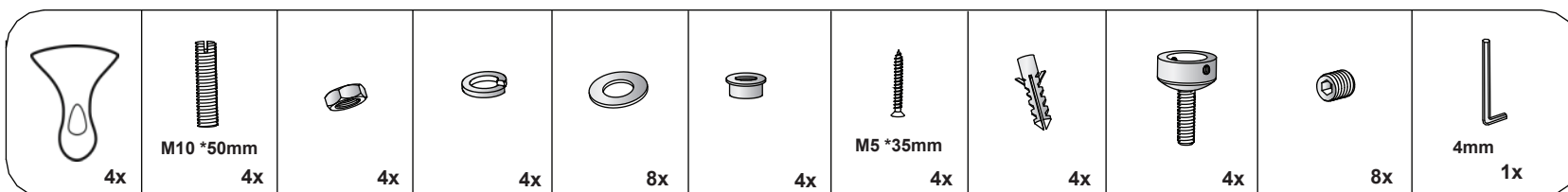

- Prior to installation check that all parts have been supplied.
- Assemble bath on a mat to protect against damage to bath surface.
- Bath diagram shown below is for reference only and bath legs fit to all baths.
- This product requires a two person lift - use proper lifting techniques.
- This installation guide does not include details of waste connection; final decision about installation of waste connection should be taken by a suitably qualified person.
- Follow each step in turn.

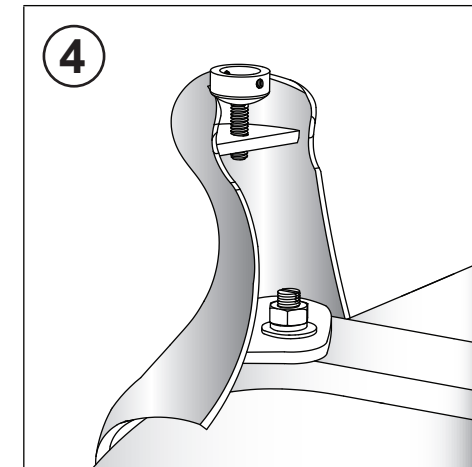
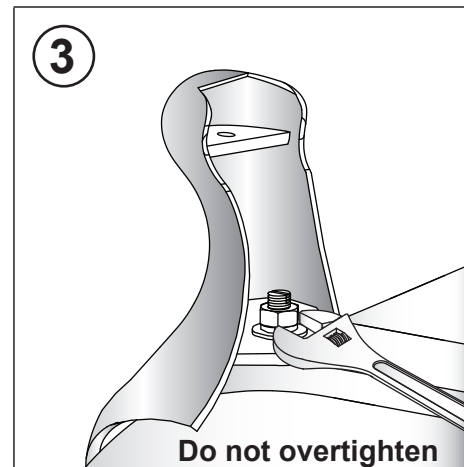
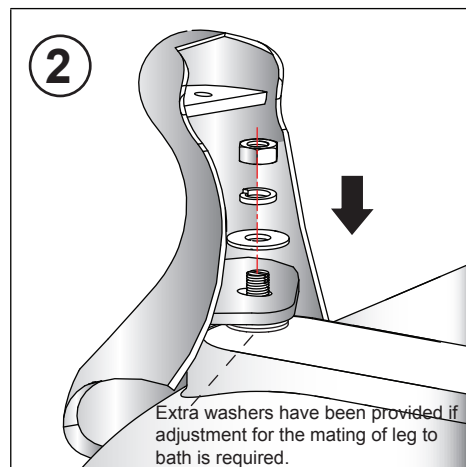
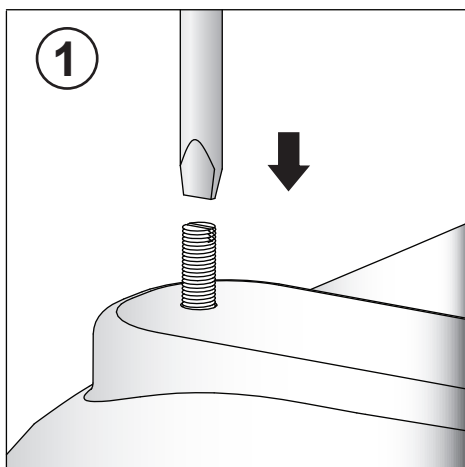

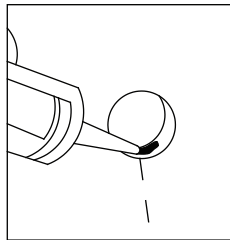
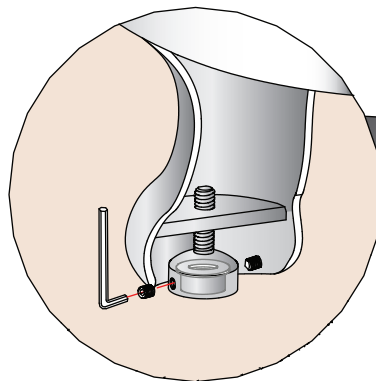
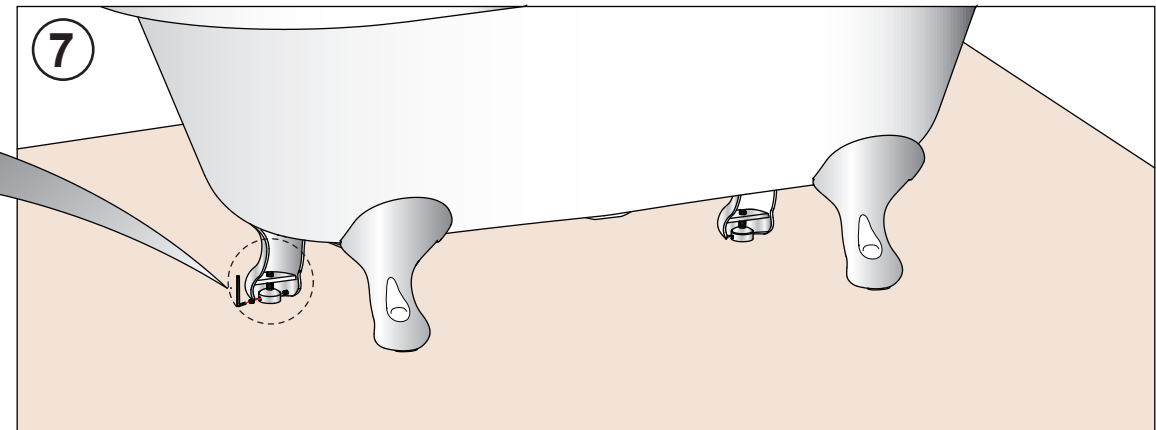
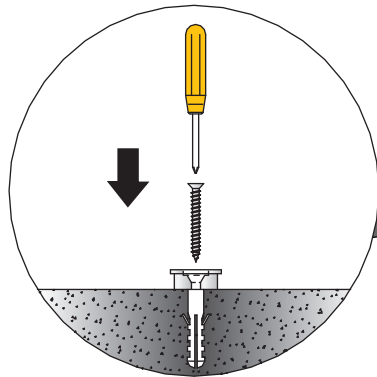
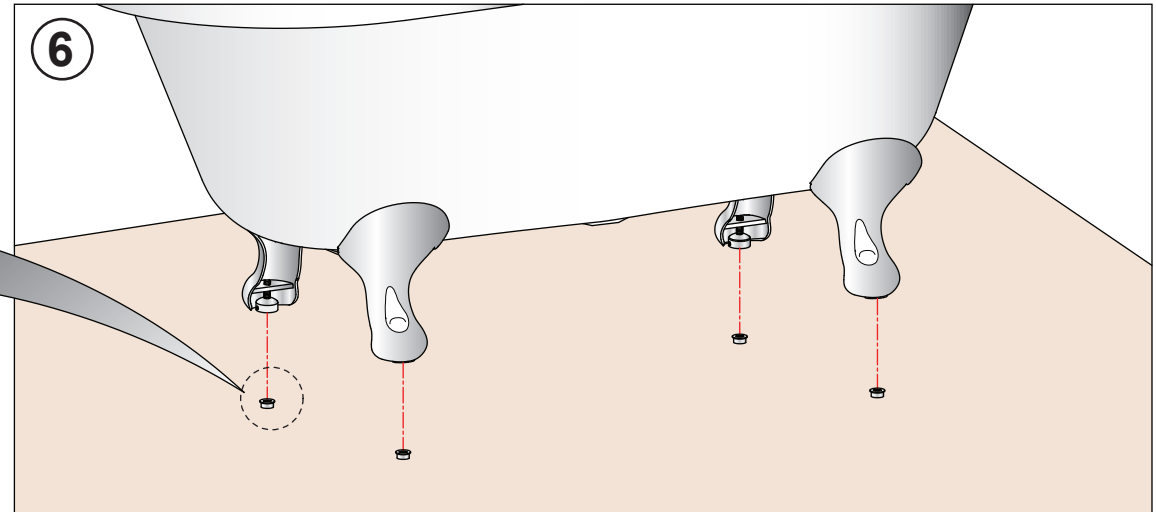
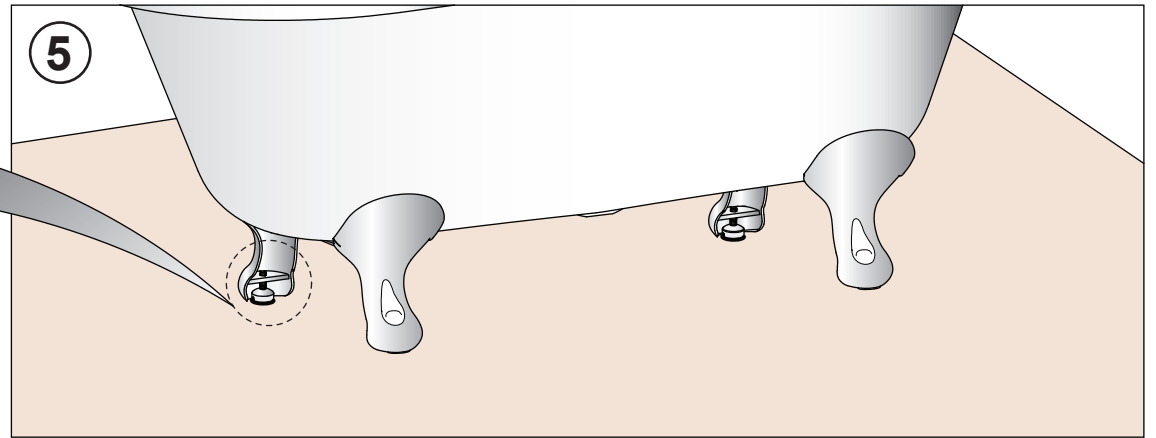
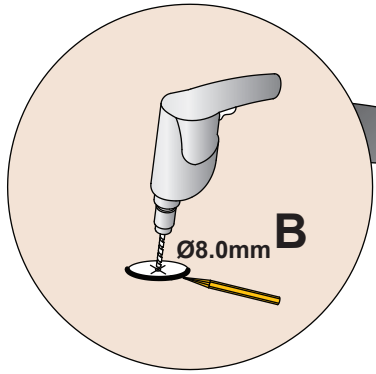
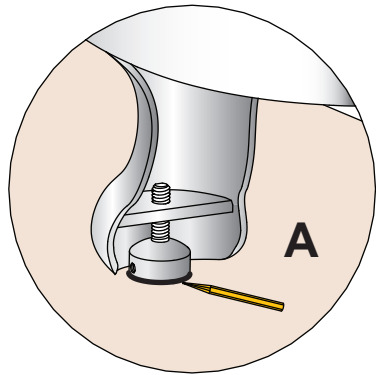

Once the bath is in the general position ready to be plumbed in, we suggest fitting the waste and overflow to the bath. Before you do this Burlington insists you smear silicone sealant around the inside of the overflow and waste to ensure a totally water tight seal. This is shown in the diagram above.