

## 167.PBBS\*\* Slotted Push Button Waste

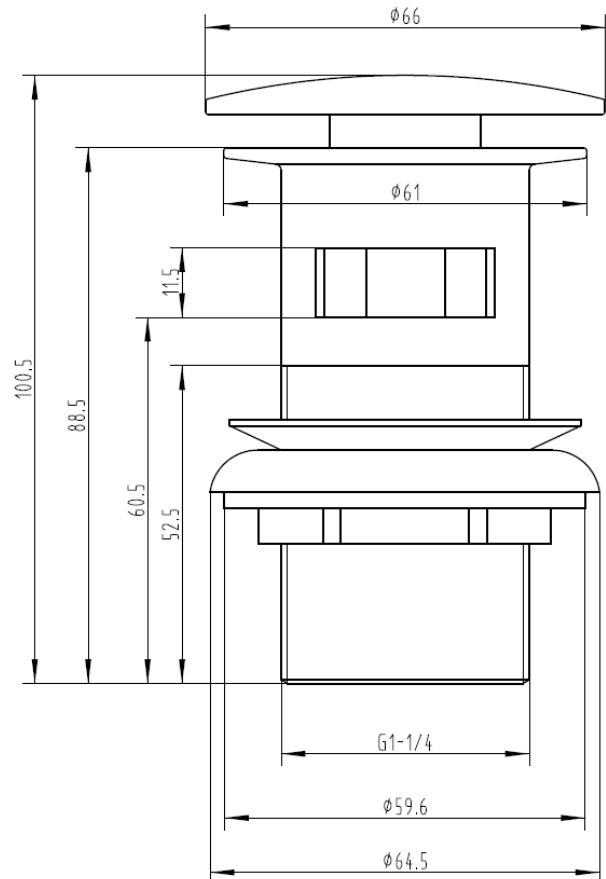

**Product Code:** Chrome 167.PBBS  
Matt Black 167.PBBSBL  
Brushed Brass 167.PBBSBB

**Construction:** SS202 Stainless steel body; SS304 Stainless steel cover; Brass clic-clac spring

**Water Pressure:** Min. 0.2 bar, Max. 5.0 bar

**Plumbing Systems:** Suitable for all plumbing systems

**Fitting:** SS202 G1-1 $\frac{1}{4}$ " BSP Male  
(Thread size 40.5 +/- 0.25mm)

**Packaging:** 47.5 x 25.5 x 40.5cm / Carton (60 boxes)  
Dimension: 10 x 7 x 7cm / box  
Weight: 0.20Kg / box

**Guarantee:** 1 year against manufacturing faults  
(excluding serviceable parts)

# 167.PBBS\*\*

THE TUNBRIDGE WELLS  
Brassware Co.

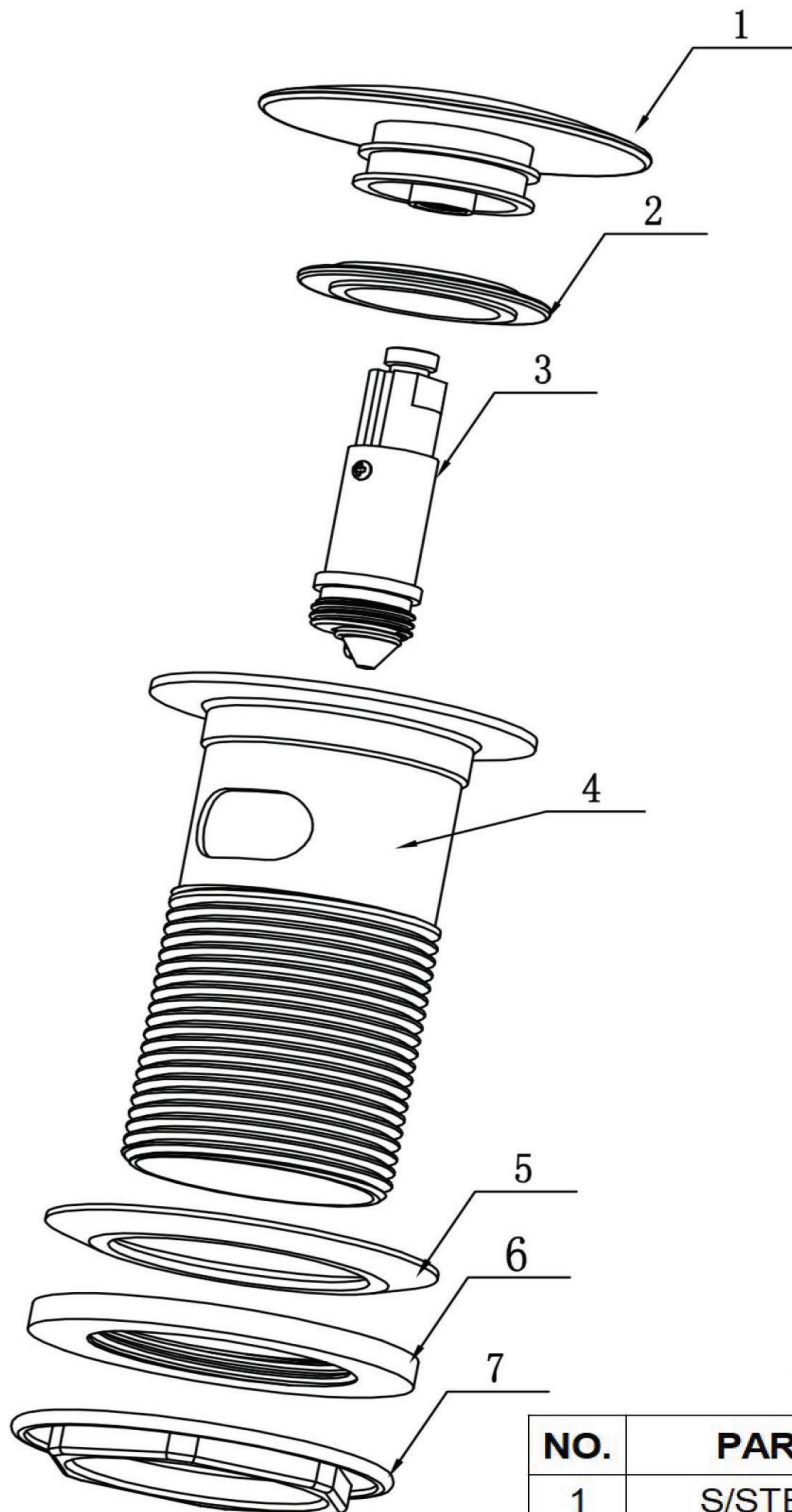

NO.	PARTS DESCRIPTION	QTY
1	S/STEEL 304 COVER CAP	1
2	SILICONE COVER CAP WASHER	1
3	BRASS CLIC-CLAC SPRING	1
4	S/STEEL 202 WASTE BODY	1
5	UPPER SILICONE WASHER	1
6	LOWER SILICONE WASHER	1
7	S/STEEL 202 LOCK NUT	1