

*Please read these instructions throughout before installing as incorrect fitting will invalidate the guarantee.  
 If you are unsure about these instructions please contact Kudos Shower Products 01539 564040*

**IMPORTANT**

Check appearance of all product - any defects must be reported to Kudos Shower Products before assembly/installation. Claims for imperfections will only be accepted prior to assembly/installation.

Suitable for both 8mm & 10mm glass thickness.

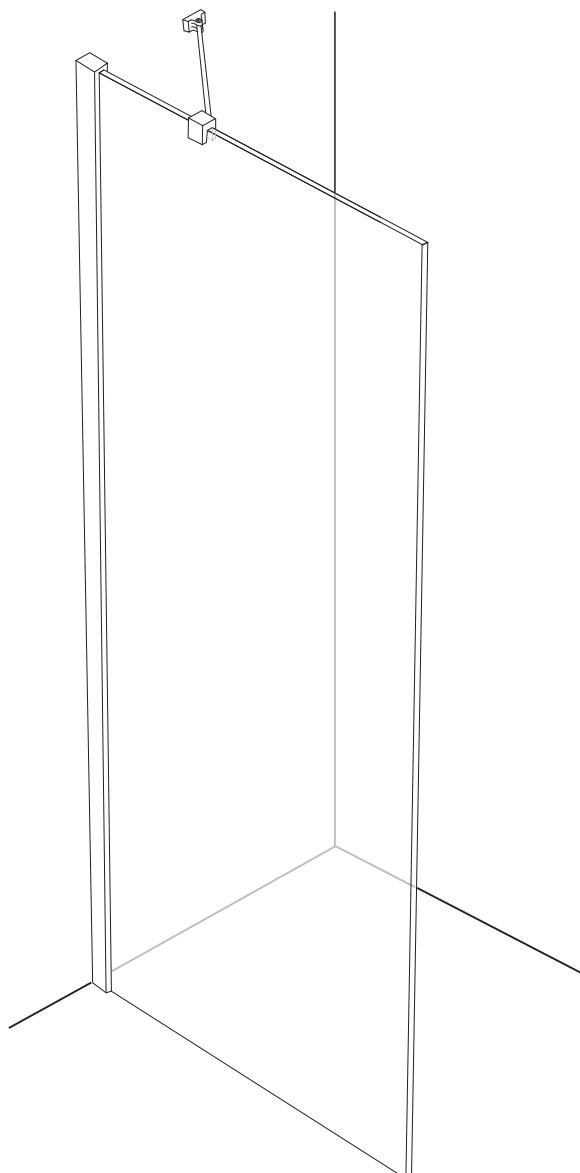

**PACK CONTENTS**

3mm Allen Key  
 Rawlplug

8x30 CSK Screw  
 Stabiliser bar

- 1 Fit glass clamp of stabiliser arm to top of glass panel (remove thin inner gasket if fitting to 10mm glass)
- 2 Position so that arm comes away from the glass at approx. 45 degrees and wall bracket makes contact with the wall, ensure rail is horizontal and mark position of wall bracket.
- 3 Remove stabiliser arm then remove screw to release the wall bracket, position to marks on wall and mark through counter sunk hole.
- 4 Using 6mm drill bit, drill hole and fit rawlplug supplied. Fix wall bracket using screw supplied.
- 5 Position glass clamp back onto glass and secure arm to wall bracket using the screw that was removed earlier.
- 6 Holding glass clamp in position, remove screw and move arm to allow access to allen key grub screw, tighten using 3mm Allan key supplied and re-attach arm with screw.

**CLEANING - general**

Use only warm soapy water and damp cloth/ sponge on a regular basis.  
 Do not use abrasive scouring powders, chemicals or aerosol cleaners - these may result in damage to the surfaces, in particular, the plated component parts.

**THESE INSTRUCTIONS ARE TO BE LEFT  
 WITH THE CONSUMER**

*Please read these instructions throughout before installing as incorrect fitting will invalidate the guarantee.  
 If you are unsure about these instructions please contact Kudos Shower Products 01539 564040*

**IMPORTANT**

Check appearance of all product - any defects must be reported to Kudos Shower Products before assembly/installation. Claims for imperfections will only be accepted prior to assembly/installation.

Suitable for both 8mm & 10mm glass thickness.

Rail can be trimmed to desired length using hacksaw.

Ceiling fixings are not supplied with this product. Fixings used should be suitable for the construction of your ceiling.

We strongly recommend that a suitable timber nogging is appropriately fitted above plasterboard/lath-type ceilings for fixing screws for optimum stability.

**PACK CONTENTS**

1x glass clamp  
 1x ceiling bracket  
 600mm long square rail

3mm Allen Key  
 2x screw cover caps

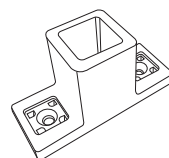

CEILING BRACKET

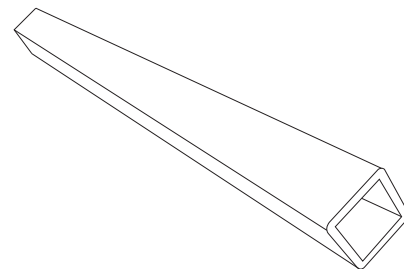

600mm SQUARE RAIL



GLASS CLAMP

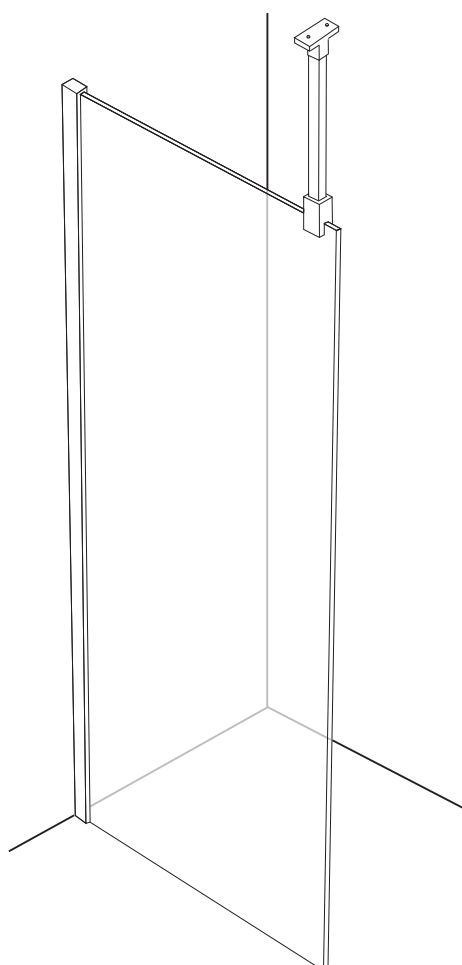

- 1** **MEASURE DISTANCE** from the top of the glass panel to the ceiling where the support arm will be secured. Deduct 15mm from this distance to find the length to cut the rail to, and then cut rail if required using a hack saw. (If distance measured is 545mm then cut rail to 530mm)
- 2** Fit glass clamp to rail end and fully tighten Allan key grub screws, also remove inner thin gasket if fitting to 10mm thick glass.
- 3** Slide ceiling bracket onto other end of rail, do not tighten grub screws, though ensure they face into the showering area, be careful not to allow the bracket to drop onto the tray.
- 4** Position Glass clamp onto glass a minimum distance of 75mm from edge of glass and slide ceiling bracket into position on ceiling, ensuring vertical, mark positions for screws.

**READ IMPORTANT NOTES**

- 5** Remove the support rail and prepare ceiling for screw fixings (not supplied). Reposition support rail onto glass and to ceiling, screw fix into place and fully tighten all Allen screws, including onto the glass panel.
- 6** Fit cover caps to ceiling bracket.

**CLEANING - general**

Use only warm soapy water and damp cloth/ sponge on a regular basis.  
 Do not use abrasive scouring powders, chemicals or aerosol cleaners - these may result in damage to the surfaces, in particular, the plated component parts.

**THESE INSTRUCTIONS ARE TO BE LEFT  
 WITH THE CONSUMER**