

## wedi Tools® | sealing tape, corners, sealing gaiters, sloped lip-end sealing tape

- Fleece-lined
- For indoors and outdoors
- Good adhesion

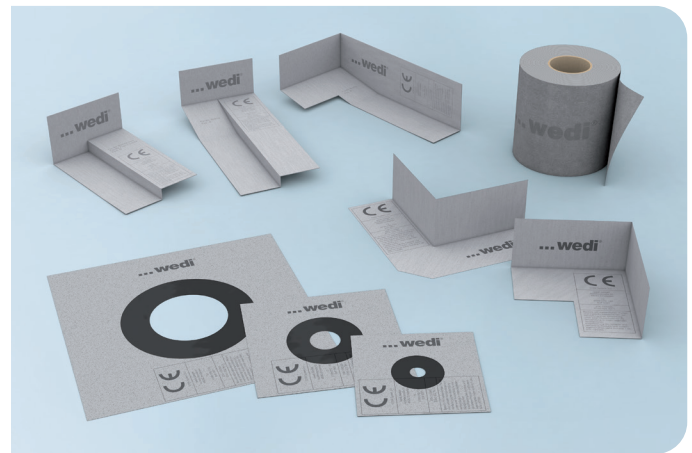

### General product description

wedi Tools sealing tape, corners, sealing gaiters and sloped lip-end sealing tape are made of a TPE-coated polypropylene fleece.

### Applications

For secure sealing of intersections such as corners, pipe connections and butt joints.

### Processing

When sealing joints and intersections, wedi Tools sealing tape, corners, sealing gaiters and sloped lip-end sealing tape must be fully bedded in wedi 520 / wedi 610 / or an epoxy-based adhesive. Firstly a contact layer should be applied using a notched trowel and then the entire sealing tape surface should be covered using a smoothing trowel. When using epoxy-based adhesives, the surface must be fully covered and finished with a quartz sand blinding.

wedi Tools sealing tapes must overlap by at least 5 cm. Use the appropriate wedi Tools sealing product when sealing joints, pipe penetrations and intersections. If you use materials according to abP/ETA, please follow the applicable guidelines.

Subject to technical changes, errors excepted.

Technical data sheet wedi Tools sealing tape, corners, sealing gaiters, sloped lip-end sealing tape. ZBBABA

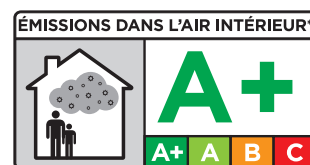

\* Information sur le niveau d'émission de substances volatiles dans l'air intérieur, présentant un risque de toxicité par inhalation, sur une échelle de classe allant A+ (très faibles émissions) à C (fortes émissions).

Information on the emission level of volatile substances in indoor air which present a risk of inhalation toxicity, on a scale of A+ (very low emissions) to C (high emissions).

 0799 (System 2+)
wedi GmbH Hofelfelstraße 51 48282 Emsdetten 13 0799-CF6-132 DoP 0001
ETA-130385 ETAG 022 Teil 3
Baupatz mit wasserdichten Platten und weiteren Komponenten zur Herstellung einer Abdichtung unter einer Nuttschicht für die Verwendung in innen liegenden Nassbereichen Klassifizierung des Systems und deklarierte Produkte- und Systemeigenschaften siehe Anhang 1 der ETA-130385

## Technical properties

Stable, longitudinally rigid and laterally elastic joint sealing tape

Type	TPE-coated polypropylene fleece
Colour	grey
Overall thickness	approx. 0.70 mm
Maximum longitudinal tensile strength	approx. 104 N / 15 mm
Maximum lateral tensile strength	approx. 23 N / 15 mm
Elongation at break, longitudinal	approx. 70%
Elongation at break, lateral	approx. 335%
Resistance to water pressure (1.5 bar)	> 1.5 bar
Resistant to chemicals	specified in accordance with construction and testing principles
UV resistance	> 500 h
Temperature resistance	-30°C / +90°C

## Technical properties corners, sealing gaiters and sloped lip-end sealing tape

Type	TPE-coated polypropylene fleece
Colour	grey
Overall thickness	approx. 0.60 mm
Maximum longitudinal tensile strength	approx. 111 N / 15 mm
Maximum lateral tensile strength	approx. 51 N / 15 mm
Elongation at break, longitudinal	approx. 113%
Elongation at break, lateral	approx. 371%
Resistance to water pressure (1.5 bar)	> 1.5 bar
Resistant to chemicals	specified in accordance with construction and testing principles
UV resistance	> 500 h
Temperature resistance	-30°C / +90°C

## Packing

---

- Sealing tape 10/50 m rolls in individual boxes (at 120 mm width)
- Inside corners, 120 × 120 mm (1 unit or 25 units/box)
- Outside corners, 115 × 115 mm (1 unit or 25 units/box)
- Sealing gaiter 120 × 120 mm (10 units/box)
- Sealing gaiter 150 × 150 mm (5 units/box)
- Sealing gaiter 250 × 250 mm (5 units/box)
- Sloped lip-end sealing tape (1 unit/box)

## Storage

---

Can be stored in a cool, dry place. Protect from sunlight.

## Safety notice

---

none

Information about finishing and application options for wedi products, technical recommendations or advice and other information provided by our employees (technical usage advice) is accurate to the best of our knowledge, but is non-binding and is given with the exclusion of any liability. It does not exempt our customers and their buyers from carrying out their own checks and trials on the suitability of the products for the intended processes and purposes.