



IMPORTANT NOTES

Before installation flush supply pipes and ensure cistern is clean and free from debris.

No sealing compound, paste, flux or solvent to be used in contact with plastic or rubber surfaces to avoid damage. Rubber washers will provide adequate seal. PTFE tape may be used on threads. No chemical block/additive to be used in this cistern.

Do not over-tighten plastic fasteners. Hand tight + ¼ turn should provide an adequate seal (8Nm recommended).

1

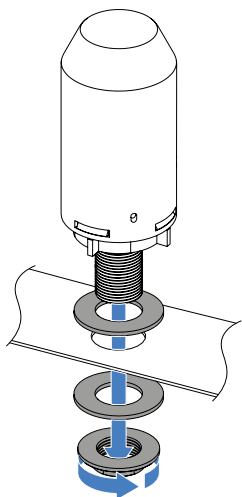

2

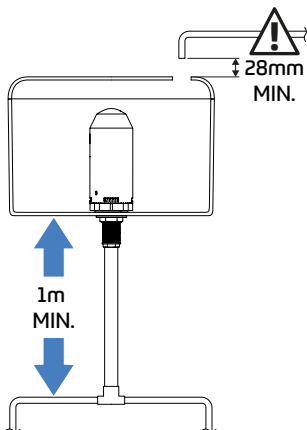

Adequate flow control and AA air gap required. Check UK water Regs.

3



Ensure flow discharges into cistern

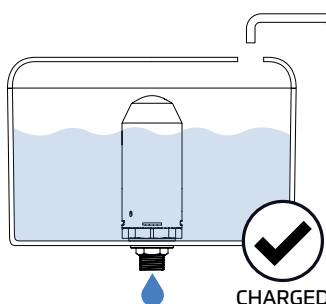
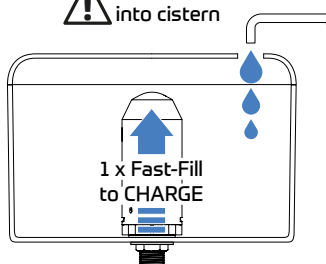

4

Final Installation Checklist

- ~ Check connections are secure and fixed correctly.
- ~ Connect and turn on water supply.
- ~ Check installation for leaks.
- ~ Installer to ensure cistern complies with UK water regulations.
- ~ Dudley *Kinetic* wash room controller available to provide smart urinal management.
- ~ Visit www.tyde.co.uk for service & maintenance information.

TYDE

295 Birmingham New Road
Dudley, West Midlands
United Kingdom
DY1 4SJ

A Thomas Dudley Business

t +44 (0)121 557 5411

f +44 (0)121 557 5345

e info@tyde.co.uk

w www.thomasdudley.co.uk/tyde

© 2021 TYDE_13095 Iss F_R326031