

Bayham Deck Mounted Bath Filler (Excl. Waste)



Product Code: Chrome 167.BHDMBF
Construction: Brass Body (CuZn40Pb2), EN CW617N (equivalent to BS CZ122) Zinc-alloy handles
Finishes: Chrome (Ni: 8-12 µm, CR: 0.25-0.3 µm)

Plumbing Systems: Suitable for all plumbing systems, Hot and Cold water pressure preferably balanced Max. supply pressure differential requirement no greater than 5:1

Water Pressure: Min. 0.5 bar, Max. 6.0 bar
Standards: Complies with BS5412, BS EN200
Certification: WRAS (1709044) approved
Cartridge: ¼ turn ¾" ceramic disc valves
Aerator: Laminar stream straightener
Fitting: Brass G¾" BSP tails

Flow Rates (litres per minute)

System Pressure	0.1 Bar	0.2 Bar	0.3 Bar	0.5 Bar	1.0 Bar	1.5 Bar	2.0 Bar	3.0 Bar	4.0 Bar	5.0 Bar
167.BHDMBF	6.4	8.5	10.1	12.8	17.7	19.0	24.9	30.5	35.1	39.3

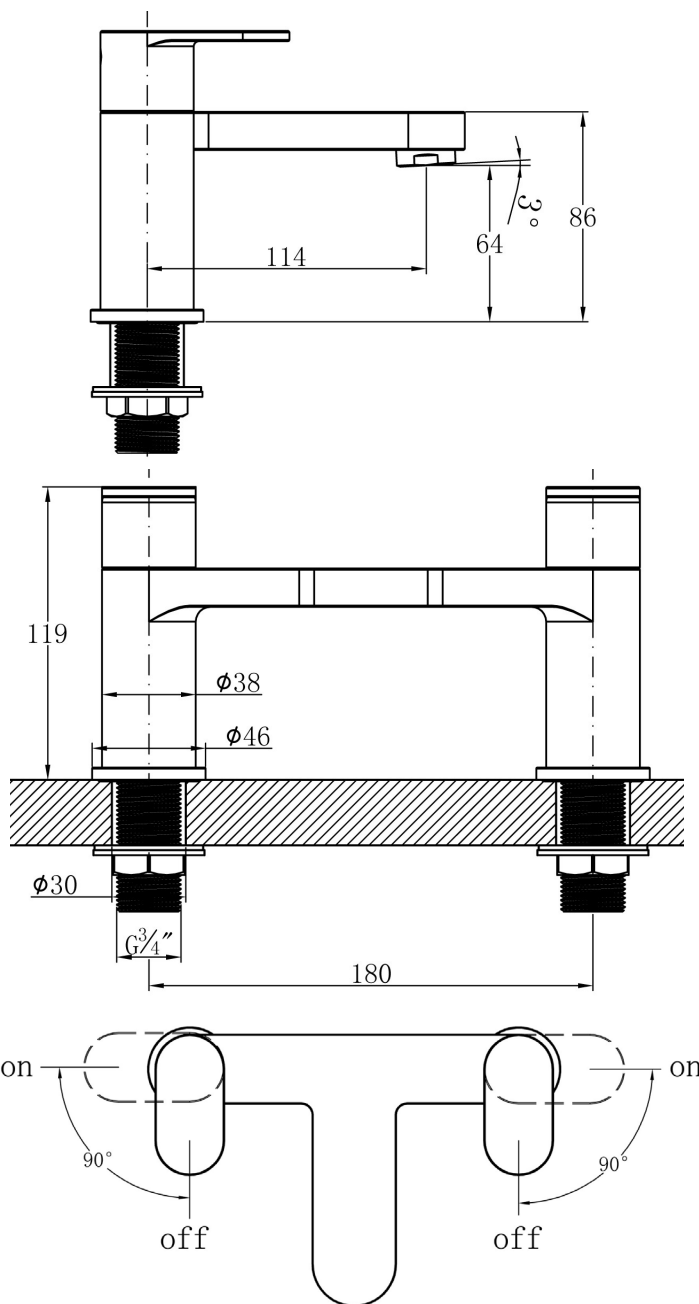

Packaging: 50 x 29.5 x 38cm / carton (4 boxes)
 Dimension: 28 x 24 x 18cm / box
 Weight: 2.35Kg / box
Guarantee: 10 years against manufacturing faults (Excluding serviceable parts)

All dimensions are in millimetres unless otherwise stated. The information contained on this page was correct at date of issue. Fitting dimensions are provided as a guide only. Some variation may occur due to manufacturing tolerances. We pursue a policy of continuing improvement in design and performance of our products and so reserve the right to change specifications without prior notice.

167.BHDMBF

THE TUNBRIDGE WELLS
Brassware Co.

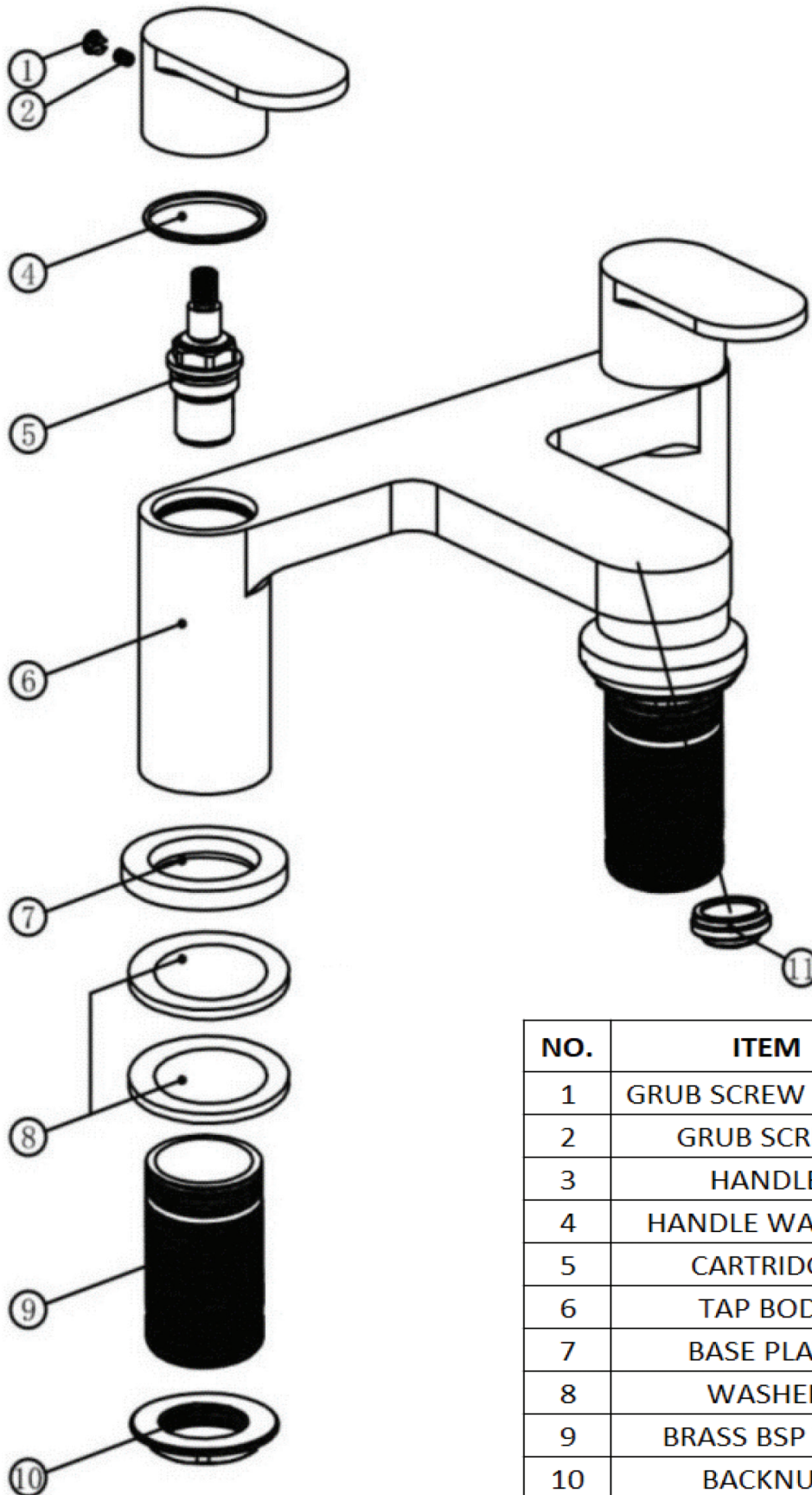

NO.	ITEM	QTY
1	GRUB SCREW COVER	2
2	GRUB SCREW	2
3	HANDLE	2
4	HANDLE WASHER	2
5	CARTRIDGE	2
6	TAP BODY	1
7	BASE PLATE	2
8	WASHER	2
9	BRASS BSP TAIL	2
10	BACKNUT	2
11	AERATOR	1