

Bedgebury Square Thermostatic Shower Mixer (Chrome)

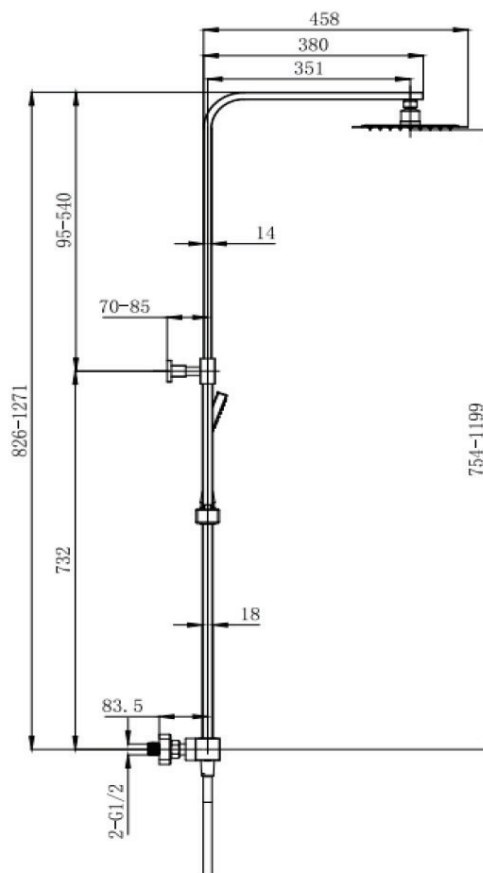
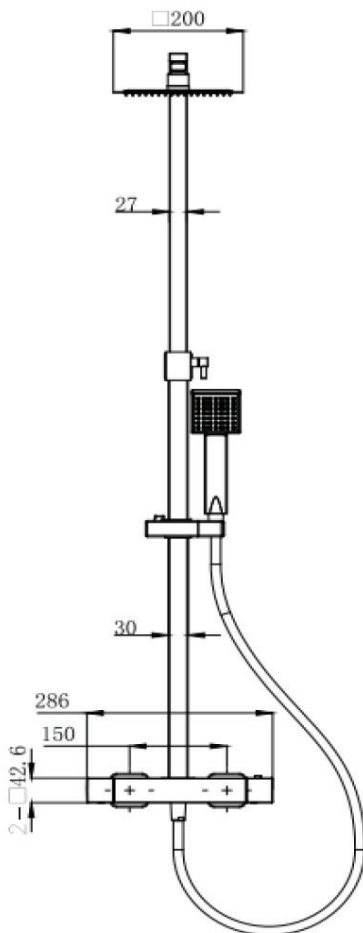

Product Code: 167.BBSTS

Construction: Valve: High Performance Polyamide (PPA)
Body & Zinc-alloy Casing; SS201 Stainless steel Riser rail & Base plates

Finishes: Chrome

Water Pressure: Min. 0.2 bar Max. 6.0 bar

Plumbing Systems: Suitable for all plumbing systems, Hot and Cold water pressure preferably balanced Max. supply pressure differential requirement no greater than 5:1

Standards: Complies with BSEN 1111

Cartridge: Thermostatic cartridge and Integrated Ceramic disc valve diverter

Fitting: S-Union connectors (Male thread offset $\frac{1}{2}$ " x $\frac{3}{4}$ " BSP with Escutcheon); Brass $\frac{1}{2}$ " BSP Male bottom outlet & $\frac{3}{4}$ " BSP Male upper outlet connection

Packaging: 93 x 43.5 x 36cm / carton (4 boxes),
Dimension: 91 x 42 x 8.5cm / box

Guarantee: 10 years against manufacturing faults (Excluding serviceable parts)

Additional Information:

- 1) Temperature: Pre-set 38°C, with push button override to 48°C
- 2) Automatic shut off in the event of hot or cold water supply failure
- 3) COOL TOUCH Bar Valve technology
- 4) Ultra Slim Shower head: square 200mm, rubber nozzles
- 5) Shower handset: ABS, Single mode, rubber nozzles
- 6) Handset holder: ABS, adjustable height
- 7) Shower hose : double interlock , 1.5m
- 8) Telescopic Adjustable height riser rail: Stainless Steel, 380mm shower arm.

Flow Rates (litres per minute)

System Pressure	0.1 Bar	0.2 Bar	0.3 Bar	0.5 Bar	1.0 Bar	1.5 Bar	2.0 Bar	3.0 Bar	4.0 Bar	5.0 Bar
167. BBSTS	4.5	6.6	8.0	10.5	15.0	-	-	-	-	-

All dimensions are in millimetres unless otherwise stated. The information contained on this page was correct at date of issue. Fitting dimensions are provided as a guide only. Some variation may occur due to manufacturing tolerances. We pursue a policy of continuing improvement in design and performance of our products and so reserve the right to change specifications without prior notice.

THE TUNBRIDGE WELLS
Brassware Co.

167.BBSTS

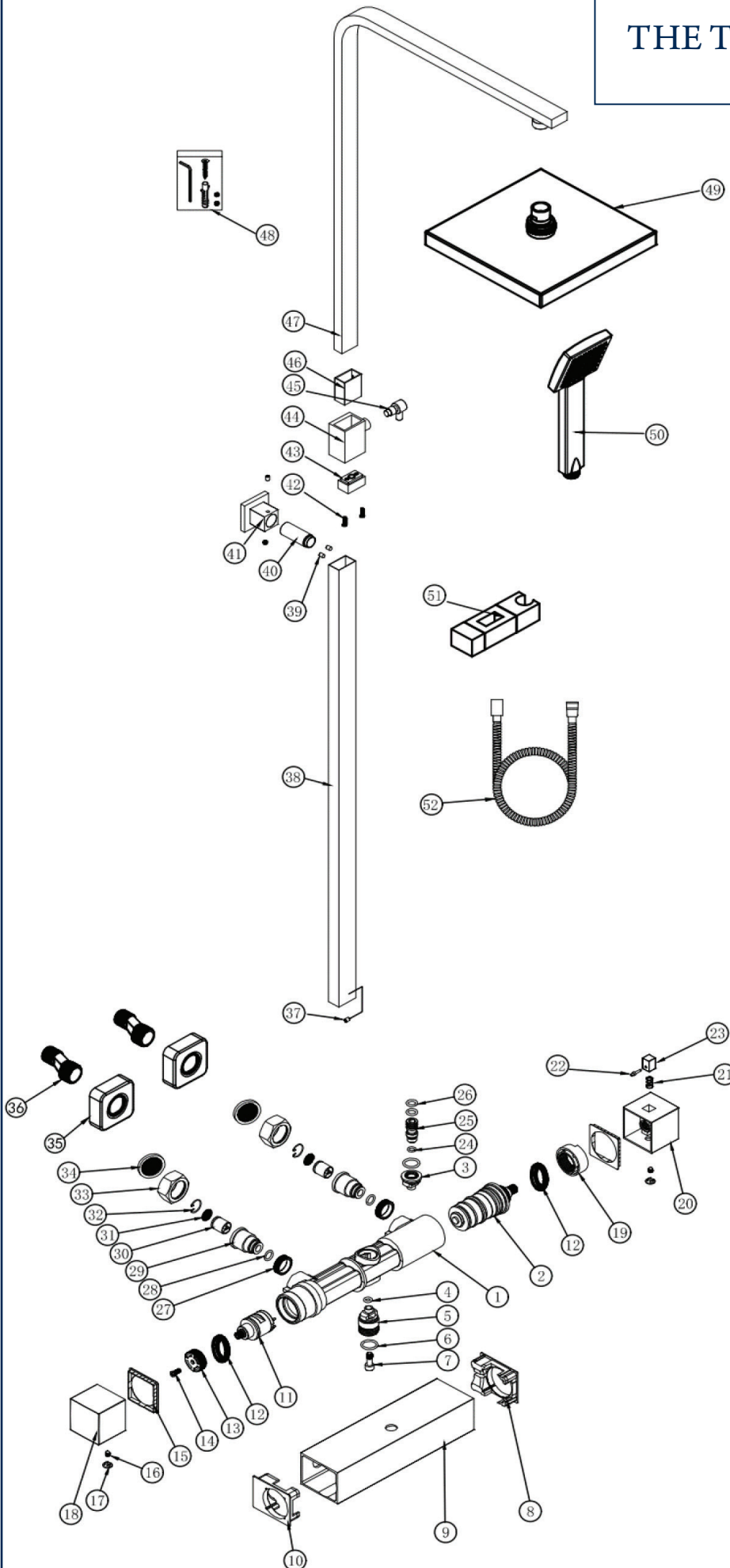

NO.	PART DESCRIPTION	QTY
1	PPA VALVE BODY	1
2	BRASS THERMOSTATIC CARTRDGE	1
3	M10*1*21.3*17.7 BRASS CONNECTOR	1
4	Ø5*2.1 NBR O-RING	1
5	G1/2*21.2*6.2*31 BRASS OUTLET CONNECTOR	1
6	Ø14*2 NBR O-RING	2
7	M6*15*9.2 SS304 S/STEEL SCREW	1
8	53.8*41.8*16.5 ZINC-ALLOY LEFT SIDE COVER	1
9	200.5*54.6*42.7*150 ZINC-ALLOY VALVE COVER	1
10	53.8*41.8*16.5 ZINC-ALLOY RIGHT SIDE COVER	1
11	CERAMIC ON/OFF VALVE	1
12	M35*1*6 BRASS CARTRIDGE NUT	2
13	Ø24*11.5 POM CARTRIDGE SLEEVE	1
14	M4*10*7.7 SS304 CROSS HEAD SCREW	1
15	41.6*41.6*4.5 POM HANDLE WASHER	2
16	M5*5 SS304 S/STEEL GRUB SCREW	2
17	Ø9.8*6 ABS CHROME COVER CAP	2
18	42*42*40 ZINC-ALLOY ON/OFF HANDLE	1
19	Ø34.5*14.5 POM THERMO STOP RING	1
20	42*42*40 ZINC-ALLOY THERMO HANDLE	1
21	Ø7*5*11.5 SS304 PUSH BUTTON SPRING	1
22	4*14.5 SS304 S/STEEL PUSH BUTTON PIN	1
23	9.8*9.8*14.5 ABS SAFETY PUSH BUTTON	1
24	Ø5.8*1.7 NBR O-RING	1
25	M10*1*12.7*29 BRASS NIPPLE CONNECTOR	1
26	Ø8.1*2 NBR O-RING	2
27	M18*1.5L BRASS INLET CONNECTOR	2
28	Ø9*1.8 NBR O-RING	2
29	M18*1.5L BRASS INLET CONNECTOR	2
30	Ø14*16 CHECK VALVE	2
31	Ø13.8*0.2 SS304 S/STEEL FILTER MESH	2
32	Ø17.7*1 SS304 S/STEEL CIRCLIP	2
33	G3/4*SS30*16 SS304 S/STEEL BACK NUT	2
34	G3/4" NBR+S/S SEMI CIRCLE FILTER WASHER	1
35	58*58*20 SS201 S/STEEL BASE PLATE	2
36	G1/2*G3/4*49 SS304 S-UNION CONNECTOR	2
37	M5*6 SS304 S/STEEL GRUB SCREW	1
38	30*18*1 SS201 S/STEEL LOWER RISER RAIL	1
39	M5*4 SS304 S/STEEL GRUB SCREW	4
40	M16*1.25*55 SS304 WALL BRACKET ROD	1
41	42*42*32 ZINC-ALLOY WALL BRACKET	1
42	M4*12*6.5 SS304 CROSS HEAD SCREW	2
43	29.5*17.5*18 SILICONE SQUARE PLUG	1
44	25.5*39*49 ZINC-ALLOY RAIL CONNECTOR	1
45	M12*1*15*28*35 ZINC-ALLOY LEVER	1
46	30*18*35 NBR RAIL CONNECTOR INSERT	1
47	27*14*0.8 SS201 S/STEEL UPPER RAIL	1
48	ST5*30 FIXING KIT BAG	1
49	200*200*64 SS304 S/STEEL SHOWER HEAD	1
50	81*240 ABS SHOWER HANDSET	1
51	30*18 ABS HANDSET HOLDER	1
52	G1/2*G1/2*14*1.5m SS304 SHOWER HOSE	1